

LED recessed luminaire

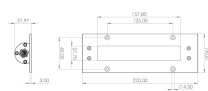
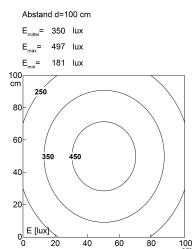

TUBELED_40 II Integrated 151010-01

Product-Nr.	151010-01
EAN:	4260556623948
Model:	TUBELED_40 II Integrated
Order number:	151010-01
Model:	TUBELED_40 II Integrated
Type:	LED recessed luminaire
Illuminant:	SMD LED
Power consumption:	~8,2 W
Lamp luminous flux:	1418 lm
Lamp luminous efficiency:	~173 lm/W
Light distribution:	Light Forming Technology
Light colour:	5700K 3-step MacAdam
Colour rendering (Ra):	>85
Supply voltage:	24V DC ± 10%
Connection (connector):	M12 A-coded
Degree of protection:	IP67/IP69K
Class of protection:	III
Glare control:	diffused safety glass
Beam angle (optics):	100°
Operating temperature:	-22 °F - 140 °F
Storage temperature:	-22 °F - 176 °F (-30 °C - +80 °C)
Lamps lifetime:	> 100,000 h (L80/B10)
Vibration resistance:	At 10 to 55 Hz (amplitude ~0.01")
Shock resistance:	Up to ~2 oz
Housing material:	Aluminium
Cover material:	tempered glass, 4 mm (0,16")
Height [B] x Width [C]:	~1.26" x ~2.91", aperture ~0.12" built-up
Length [A]:	~8,66"
Weight (net):	~18 oz
Gross weight:	~22 oz
Risk group (DIN EN 62471):	Free group
Markings:	CE, UKCA, ETL Listed (5003529), D mark
Dimmable:	Optional via accessories
Made in:	Germany